



Technical Data

PLASTIC TUBES

Cylindrical in accordance with **DIN EN 13045**

Material

- PE-HD (high density polyethylene)
- PE-LD (low density polyethylene)
- PE-LLD (linear PE low density) material mix

Manufacturing process

- Tube shoulder is welded to the seamlessly extruded body

Special design

- Coex-Tube with specific barrier properties, special haptic and visual effects
- Highly transparent tubes
- Tubes with UV-protection
- Tamper evident seal out of aluminium or plastic
- Special neck finish for pushed on caps

Decoration

- Clear, white or coloured finish of tube body and shoulder
- Rotary offset printing up to 7 colours
- Silk-screen print up to 7 colours
- Gold-, silver- and coloured foil blocking
- Clear varnish in mat or gloss finish in order to protect inks and to reduce permeability of tube body
- Labelling
- Hybrid printing (flexographic and silk-screen)

Caps

- Screw caps
- Flip-top caps screwed or pushed on and orientated to the print
- Sleeved caps
- Closure with Tamper Evident
- Bicolor caps

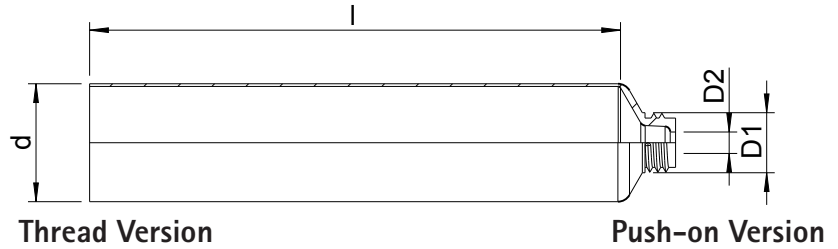

Thread Version

Push-on Version

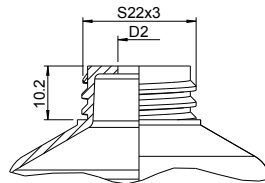
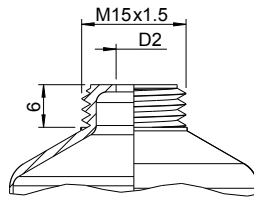
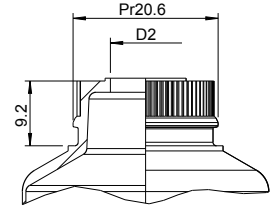
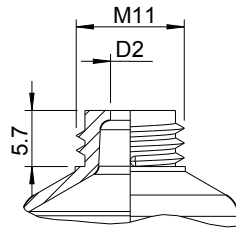

Nominal diameter d	Max. Length l	Thread Version	Push-on Version	Orifice D ₂
19	120	M11	-	1.5-5.5
22	150	M11	-	1.5-5.5
25	160	M11	-	1.5-5.5
30	180	M15	-	1.0-9.5
35	190	M15	-	1.0-9.5
35	190	-	Pr 20.6	10
40	190	M15	-	1.0-9.5
40	190	-	Pr 20.6	10
40	190	S 22 x 3	-	14
50	200	S 22 x 3	-	1.5-15
50	200	-	Pr 20.6	10

Special Tube heads

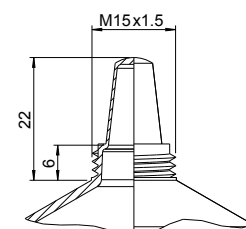
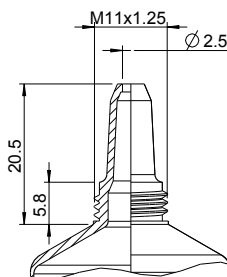
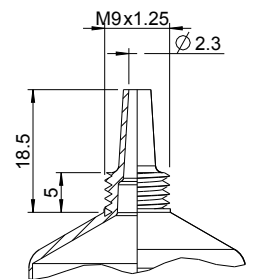
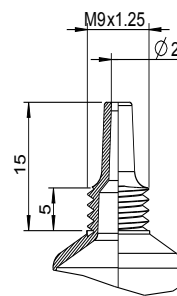
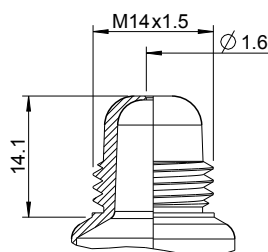

Nominal diameter d	Thread D ₁	Type	Height	Orifice D ₂
19	M9	elongated nozzle	15	2.0
25	M14	spherical head	14.1	1.6
30	M9	elongated nozzle	18.5	2.3
30	M11	elongated nozzle	20.5	2.5
50	M15	elongated nozzle	22	closed

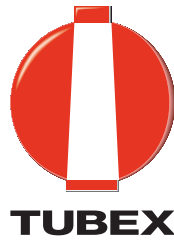

Technical Data

Filling Volume for PLASTIC TUBES

Volume	Diameter in mm						
	19	22	25	30	35	40	50
10 ml	60						
15 ml	80	65					
20 ml	100	80	70				
25 ml		95	80				
30 ml		110	95	80			
40 ml			115	95			
50 ml				110	90		
60 ml				125	100		
75 ml				140	115	105	
80 ml					125	110	
100 ml					150	125	110
125 ml					175	145	115
150 ml						165	130
200 ml							160
250 ml							185
275 ml							200
300 ml							215
Min. Length	55	60	70	70	70	70	85
Max. Length	120	150	160	180	190	190	215

Areas with white background represent the recommended tube length.